

Benedictine Sisters Retreat Center Site Map

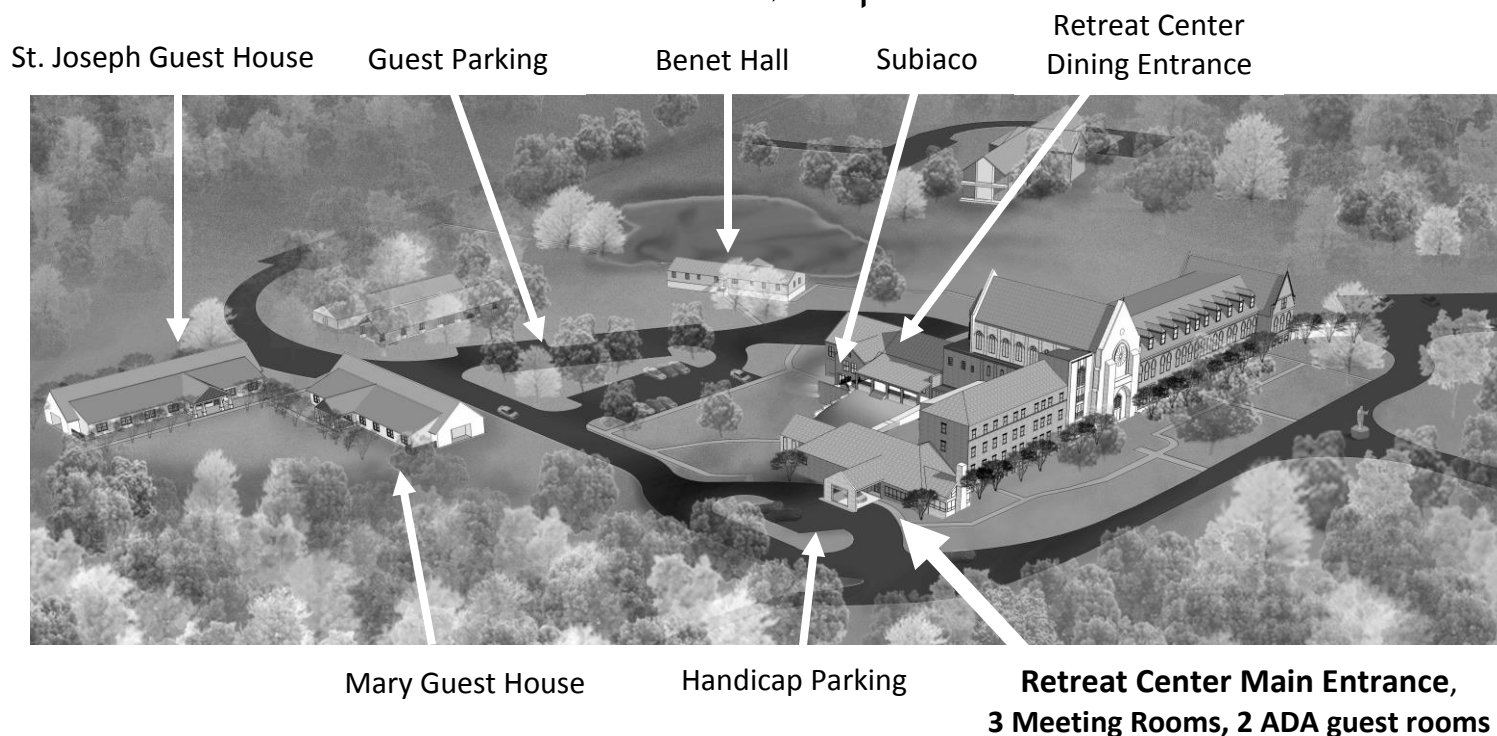

Description of Overnight Guest Accommodations

Mary Guest House and St. Joseph Guest House

Each guest house features:

- Twelve double-occupancy guest rooms with private bath (*one guest room in each building meets ADA requirements*)
- Spacious living room/gathering space with comfortable furnishings
- Kitchenette with refrigerator, microwave, coffee maker, and dining table
- Storm refuge rooms
- Pleasant front porch with lovely, pastoral views
- Convenient parking and access to meeting areas
- Complementary Wi-Fi access in the gathering space

Subiaco

A dedicated area for private retreatants

- 5 private rooms with private bath
- Common living room and kitchenette
- Complementary Wi-Fi access

Annunciata Hall

- 2 single-occupancy ADA-rooms, each with private bath
- Convenient (level and/or sloped) access to meeting and dining areas
- Complementary Wi-Fi access

Benet Hall

- Ranch-style house containing 18 beds in 11 guest rooms
- Four hallway baths
- Living room; kitchenette; front porch overlooking Lake Maurus

Benedictine Sisters Retreat Center

Meeting Room Descriptions

Three meeting rooms are available to meet the needs of groups of varying sizes.

St. Benedict (shaded **blue** on attached diagram)

Maximum Capacity: Approx. 100

Features: Generously-sized gathering space for larger groups; serving counter with sink for refreshment and beverage service; partition allows for dividing room into two smaller spaces.

St. Scholastica (shaded **green** on attached diagram)

Maximum Capacity: Approx. 60

Features: Ample seating for a medium-sized group with fireplace nook and expansive windows overlooking Novice's Park and Cemetery Road; serving counter with sink for refreshment and beverage service.

St. Gertrude (shaded **rose** on attached diagram)

Maximum Capacity: Approx. 12

Features: Bright, sunny room ideal for a smaller gathering such as a prayer group or planning meeting

Additional features:

- Covered entrance for drop-off and unloading
- Convenient parking
- Complementary Wi-Fi
- Flexible meeting configurations ranging from auditorium style to classroom style
- Gift shop
- Convenient access to Retreat Center dining via indoor corridor or outdoor courtyard and porch
- Refrigerator for storage of beverages and snacks
- Comfortable sitting areas for visiting or relaxing
- Two handicap-accessible overnight guest rooms
- Handicap-accessible restroom adjacent to meeting areas
- Access to monastic library and spiritual direction rooms
- Staff offices located near meeting rooms for ready assistance with group needs
- A small prayer chapel is available for the use of all guests
- Complementary meeting equipment as available: podium, tripod presentation easel (without pad), tripod display easels, portable chalk board. One portable microphone/amplifier unit is available.
- Equipment available for a small usage fee includes flat-screen monitor with DVD player on portable cart, laptop computer, CD player, tripod flip chart presentation easel with flip pads provided.

Benedictine Sisters Retreat Center Meeting Room Diagram

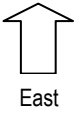

To Mary and Joseph
Guest Houses

To
Benet Hall
& Subiaco

Retreat
Center
Dining

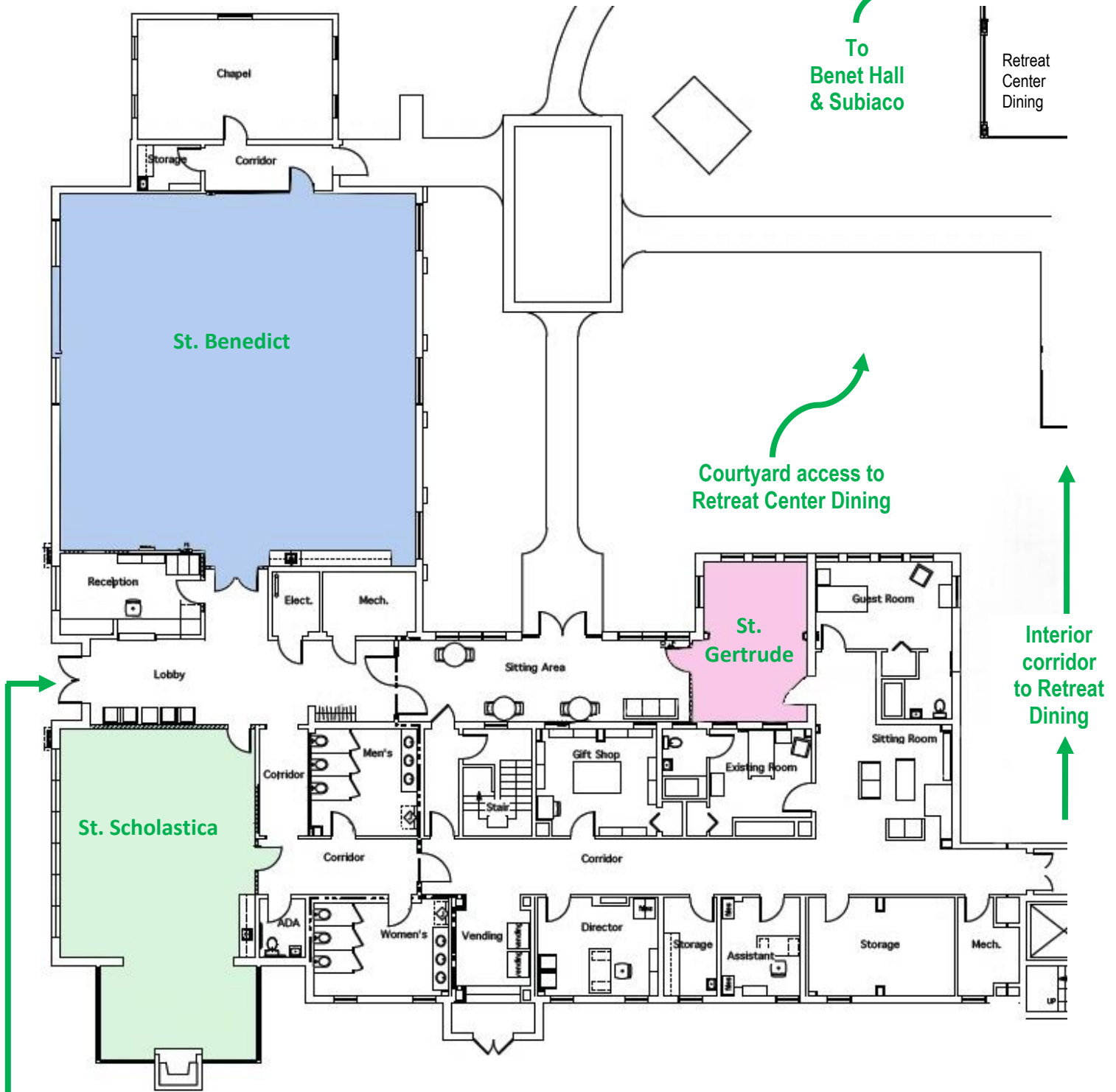

Courtyard access to
Retreat Center Dining

Interior
corridor to
Retreat
Dining

Retreat Center
Entrance with
covered drop-off

Ample parking is available to the rear of the meeting room areas and near the guest houses. A few parking spaces are available at the Retreat Center entrance covered drop-off.